



Disinfection fluid Monitor Series

Online Membrane Residual Chlorine Meter T4055

Function

Online residual chlorine meter is a microprocessor-based water quality online monitoring control instrument.

Typical Use

This instrument is widely used in online monitoring of water supply, tap water, rural drinking water, circulating water, washing film water, disinfectant water, pool water. and other industrial processes. It continuously monitors and controls residual chlorine, pH and temperature value in aqueous solution.

Mains Supply

85~265VAC±10%,50±1Hz, power ≤3W;

9~36VDC, power consumption≤3W;

Measuring Range

Residual Chlorine: 0~20ppm; 0~20mg/L;

pH: -2~16pH;

Temperature: 0~150 °C .

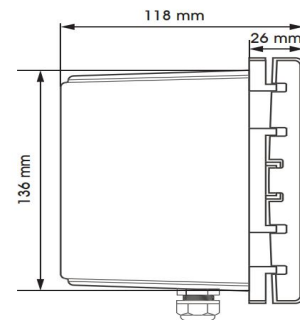
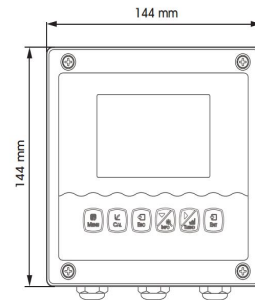

Online Membrane Residual Chlorine Meter T4055

Features

1. Large display, standard 485 communication, with online and offline alarm, 98*98*130mm meter size, 92.5*92.5mm hole size, 3.0 inch large screen display.
2. The data curve recording function is installed, the machine replaces the manual meter reading, and the query range is arbitrarily specified, so that the data is no longer lost.
3. Built-in various measurement functions, one machine with multiple functions, meeting the requirements of various measurement standards.
4. The design of the whole machine is waterproof and dustproof, and the back cover of the connection terminal is added to extend the service life in harsh environments.
5. Panel/wall/pipe installation, three options are available to meet various industrial site installation requirements.

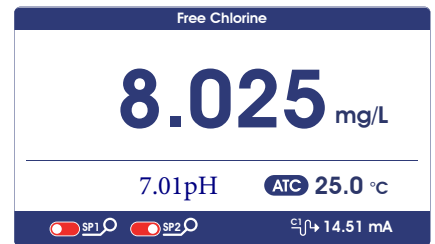

Measurement Mode



Calibration Mode



Field Calibration



Setting mode

Electrical connections

Electrical connection The connection between the instrument and the sensor: the power supply, output signal, relay alarm contact and the connection between the sensor and the instrument are all inside the instrument. The length of the lead wire for the fixed electrode is usually 5-10 meters, and the corresponding label or color on the sensor Insert the wire into the corresponding terminal inside the instrument and tighten it.

Instrument installation method

Embedded installation

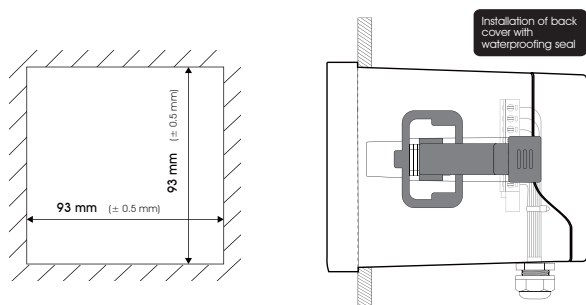

Embedded mounting Cut-out size

Embedded the instrument into the square hole, and fix it with the provided clasp.

Wall mounted installation

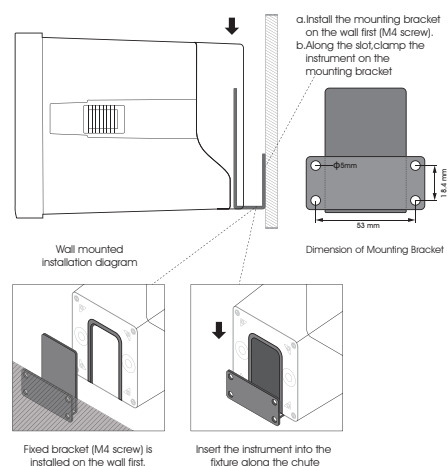

Fixed bracket (M4 screw) is installed on the wall first.

Insert the instrument into the fixture along the chute

Technical specifications

Measurement range	0.005~20.00mg/L ; 0.005~20.00ppm
Measurement unit	Membrane
Resolution	0.001mg/L ; 0.001ppm
Basic error	±1%F.S
Measurement range	-2~16.00pH
Measurement unit	pH
Resolution	0.001pH
Basic error	±0.01pH
Temperature	-10~150.0°C(Based on sensor)
Temperature Resolution	0.1°C
Temperature Basic error	±0.3°C
Current output	2 groups: 4~20mA
Signal output	RS485 Modbus RTU
Other functions	Data record
Three relay control contacts	2 groups:5A 250VAC,5A 30VDC
Optional power supply	85~265VAC,9~36VDC,power consumption≤3W
Working conditions	No strong magnetic field interference around except the geomagnetic field.
Working temperature	-10~60°C
Relative humidity	≤90%
Waterproof rating	IP65
Weight	0.6kg
Dimensions	98×98×130mm
Installation opening size	92.5×92.5mm
Installation methods	Panel & wall mounted or pipeline

CS5763 Residual Chlorine Sensor (Membrane)



Model No.	CS5763
Measurement method	Membrane
Housing material	POM+316L Stainless
Waterproof grade	IP68
Measurement range	0 - 20.00 mg/L
Accuracy	±0.05mg/L;
Pressure resistance	≤0.3Mpa
Temperature compensation	NTC10K
Temperature range	0-50℃
Calibration	Chlorine-free water, water sample calibration
Connection methods	4 core cable
Cable length	Standard 5m cable, can be extended to 100m
Installation thread	NPT3/4"
Application	Tap water, disinfectant fluid, etc.

CS1500 pH Sensor



Model No.	CS1500
Measure material	Glass
Reference system	Ag/AgCl/KCl
Electrolyte solution	3.3M KCl
Membrane resistance	<600MΩ
Housing material	PP
Liquid junction	Porous ceramics
Waterproof grade	IP68
Measurement range	2-12pH
Accuracy	±0.05pH
Pressure resistance	≤0.3Mpa
Temperature compensation	None
Temperature range	0-80℃
Calibration	Sample calibration, standard liquid calibration
Double Junction	Yes
Cable length	Standard 5m cable, can be extended to 100m
Installation thread	PG13.5
Application	Common water quality